

June 2026

IFC+SG parameter review and update workflow from authoring model



01 Workflow



IFC+SG parameter review and update workflow from authoring model

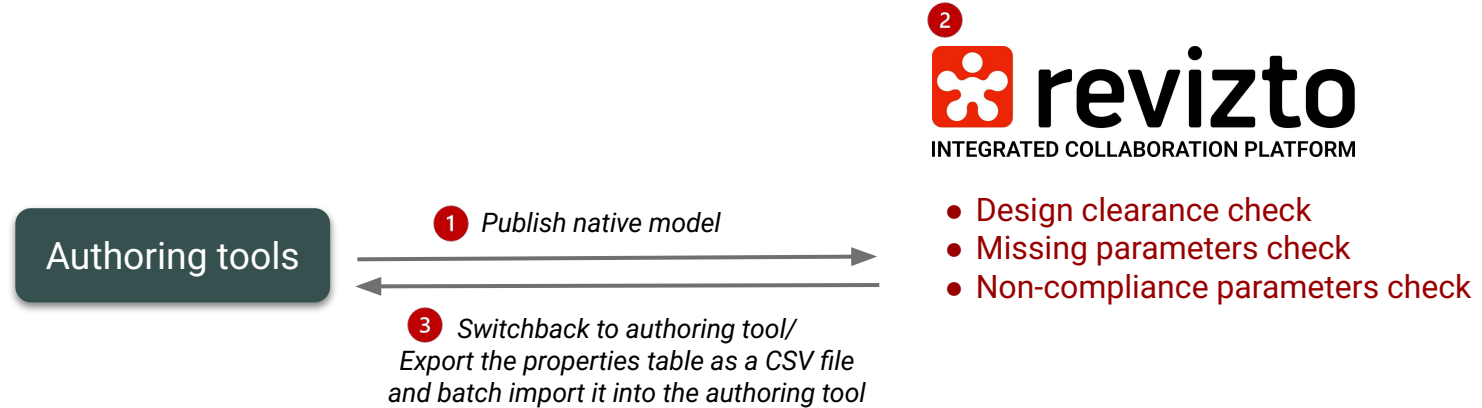

- 1** Direct publish models from authoring tools into Revizto via plugin
- 2** Coordinate and manage models within Revizto
- 3** 1. Use one-click switchback from Revizto to the authoring tool to address design issues
2. Export properties to a CSV file via the Selection Inspector, and batch import them into the authoring tool using Dirroots connector

1- Direct publish models from authoring tools into Revizto via plugin

Plug-in on Revit

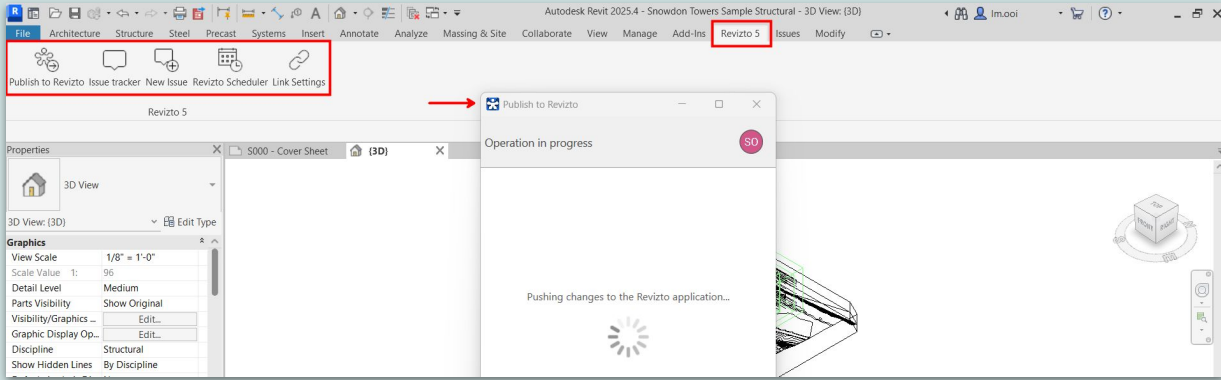

Plug-in on ArchiCAD

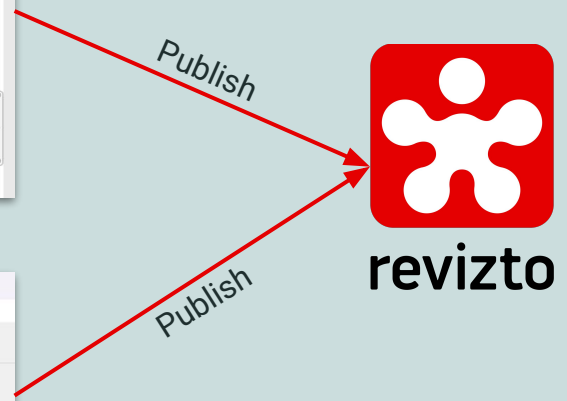
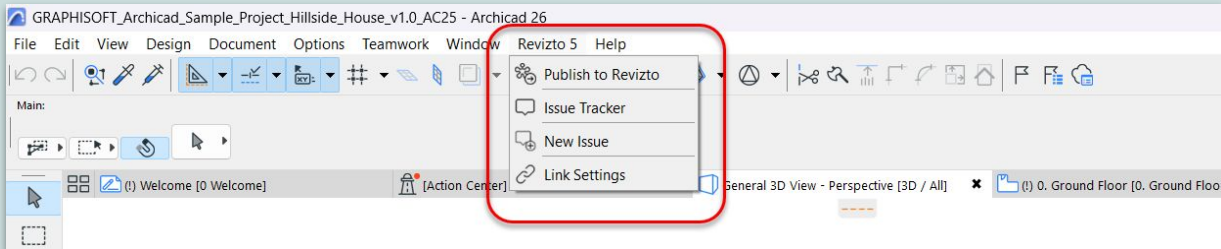

2- Coordinate and manage models within Revizto

Clashing type



- Clashes
 - Hard clash**
 - Tolerance
- Clearance
 - Clearance
 - Directly above
 - Directly below
- Inside
- Duplicate
- Object A requires object B
 - Object A requires object B in proximity
 - Object A requires object B directly above
 - Object A requires object B directly below
 - Object A requires object B inside

Hard clash
Find intersecting objects.
This can include touching objects and/or the objects that are fully inside one another.

Clash Automation

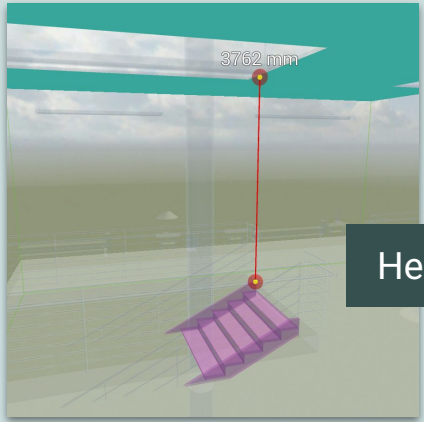

Headroom Clearance

Clash Automation

Clash test is being edited by you. Only you can edit the clash test until you relinquish it.

Filters

Clash state	All	New All	Status	All	Selection	None	Search sets	None	Grid intersections	All	Level	All	More
3RD STOREY Corridor 328	182	1	1	1	1	1	1	1	1	1	1	1	NOT REVIEWED
3RD STOREY Stair 327	183	1	1	1	1	1	1	1	1	1	1	1	NOT REVIEWED
3RD STOREY Tank 326	184	1	1	1	1	1	1	1	1	1	1	1	NOT REVIEWED
3RD STOREY Conference 325	185	1	1	1	1	1	1	1	1	1	1	1	NOT REVIEWED
3RD STOREY Advisors 324	186	1	1	1	1	1	1	1	1	1	1	1	NOT REVIEWED
3RD STOREY Electrical 323	187	1	1	1	1	1	1	1	1	1	1	1	NOT REVIEWED
3RD STOREY Administration 322	188	1	1	1	1	1	1	1	1	1	1	1	NOT REVIEWED
3RD STOREY Open Office 321	189	1	1	1	1	1	1	1	1	1	1	1	NOT REVIEWED
3RD STOREY Media Review 320	190	1	1	1	1	1	1	1	1	1	1	1	NOT REVIEWED
3RD STOREY Media Review 319	191	1	1	1	1	1	1	1	1	1	1	1	NOT REVIEWED
3RD STOREY Lobby 318	192	1	1	1	1	1	1	1	1	1	1	1	NOT REVIEWED
3RD STOREY Electrical 317	193	1	1	1	1	1	1	1	1	1	1	1	NOT REVIEWED
3RD STOREY Storage 316	194	1	1	1	1	1	1	1	1	1	1	1	NOT REVIEWED
3RD STOREY Instruction 315	195	1	1	1	1	1	1	1	1	1	1	1	NOT REVIEWED
3RD STOREY Instruction 314	196	1	1	1	1	1	1	1	1	1	1	1	NOT REVIEWED
3RD STOREY Instruction 313	197	1	1	1	1	1	1	1	1	1	1	1	NOT REVIEWED
3RD STOREY Stair 312	198	1	1	1	1	1	1	1	1	1	1	1	NOT REVIEWED

Settings

- Clash test name: Rooms Fire Sprinkles
- Selection: EC Rooms and Spaces, EC Fire Alarm Devices
- Ignore clashes: Active rules: 0
- Clashing type: Object A requires object B inside

View & screenshot

- Issue automation: None
- Access rights: Administrators (1)

Object A = Rooms and Spaces
Object B = Fire Alarm Devices

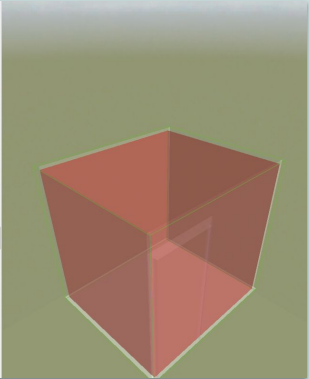

Required Object

2- Coordinate and manage models within Revizto

Design review with ruler



Measure corridor width

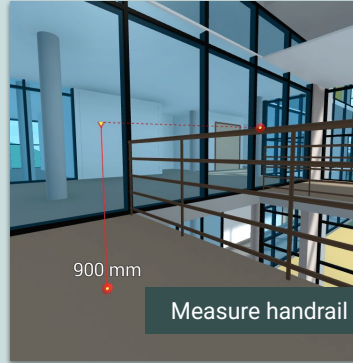
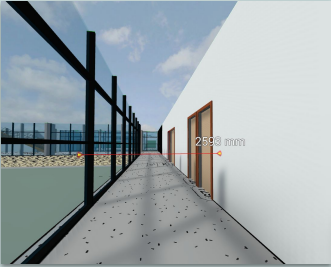

Measure handrail safety height

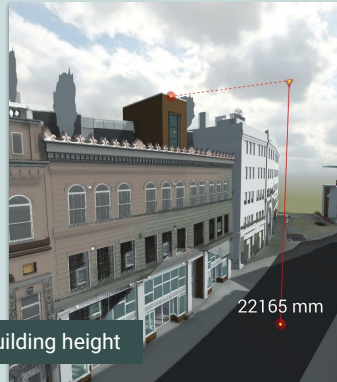

Measure overall building height

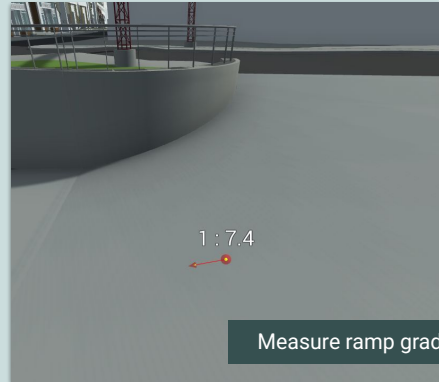

Measure ramp gradient

2- Coordinate and manage models within Revizto

Review undefined parameter in tabular format

1. Search Set

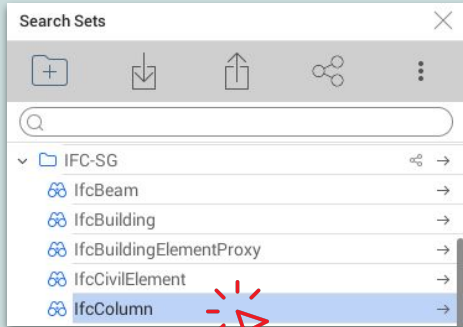

Double-click

2. Selection Inspector

Item	Type	Name	IFC Param->Export	IFC Param->Accredit	IFC Param->Arrange	IFC Param->Breath	IFC Param->Column	IFC Param->Connect	IFC Param->Connect	IFC Param->Connect	IFC Param->Connect	IFC Param->Diameter	IFC Param->EndStorey	IFC Param->MainRf	Constraints
300mm	M_Concrete-Round-Column	IfcColumn	Yes	Multi-Tier	300 mm	Yes	Detail 1	Detail 1	Pinned	Pinned	CIS	<Not defined>	6H21+6H25	A-1	[X]
300mm	M_Concrete-Round-Column	IfcColumn	Yes	Multi-Tier	300 mm	Yes	Detail 1	Detail 1	Pinned	Pinned	CIS	<Not defined>	6H21+6H25	B-1	[X]
300mm	M_Concrete-Round-Column	IfcColumn	Yes	Multi-Tier	300 mm	Yes	Detail 1	Detail 1	Pinned	Pinned	CIS	<Not defined>	6H21+6H25	O-1	[X]
300mm	M_Concrete-Round-Column	IfcColumn	Yes	Multi-Tier	300 mm	Yes	Detail 1	Detail 1	Pinned	Pinned	CIS	<Not defined>	6H21+6H25	D-1	[X]
300mm	M_Concrete-Round-Column	IfcColumn	Yes	Multi-Tier	300 mm	Yes	Detail 1	Detail 1	Pinned	Pinned	CIS	<Not defined>	6H21+6H25	E-1	[X]
300mm	M_Concrete-Round-Column	IfcColumn	Yes	Multi-Tier	300 mm	Yes	Detail 1	Detail 1	Pinned	Pinned	CIS	<Not defined>	6H21+6H25	F-1	[X]
300mm	M_Concrete-Round-Column	IfcColumn	Yes	Multi-Tier	300 mm	Yes	Detail 1	Detail 1	Pinned	Pinned	CIS	<Not defined>	6H21+6H25	G-1	[X]
300mm	M_Concrete-Round-Column	IfcColumn	Yes	Multi-Tier	300 mm	Yes	Detail 1	Detail 1	Pinned	Pinned	CIS	<Not defined>	6H21+6H25	H-1	[X]
300mm	M_Concrete-Round-Column	IfcColumn	Yes	Multi-Tier	300 mm	Yes	Detail 1	Detail 1	Pinned	Pinned	CIS	<Not defined>	6H21+6H25	J-1	[X]
300mm	M_Concrete-Round-Column	IfcColumn	Yes	Multi-Tier	300 mm	Yes	Detail 1	Detail 1	Pinned	Pinned	CIS	<Not defined>	6H21+6H25	A-2	[X]
300mm	M_Concrete-Round-Column	IfcColumn	Yes	Multi-Tier	300 mm	Yes	Detail 1	Detail 1	Pinned	Pinned	CIS	<Not defined>	6H21+6H25	B-2	[X]
300mm	M_Concrete-Round-Column	IfcColumn	Yes	Multi-Tier	300 mm	Yes	Detail 1	Detail 1	Pinned	Pinned	CIS	<Not defined>	6H21+6H25	C-2	[X]
300mm	M_Concrete-Round-Column	IfcColumn	Yes	Multi-Tier	300 mm	Yes	Detail 1	Detail 1	Pinned	Pinned	CIS	<Not defined>	6H21+6H25	D-2	[X]
300mm	M_Concrete-Round-Column	IfcColumn	Yes	Multi-Tier	300 mm	Yes	Detail 1	Detail 1	Pinned	Pinned	CIS	<Not defined>	6H21+6H25	E-2	[X]
300mm	M_Concrete-Round-Column	IfcColumn	Yes	Multi-Tier	300 mm	Yes	Detail 1	Detail 1	Pinned	Pinned	CIS	<Not defined>	6H21+6H25	F-2	[X]
300mm	M_Concrete-Round-Column	IfcColumn	Yes	Multi-Tier	300 mm	Yes	Detail 1	Detail 1	Pinned	Pinned	CIS	<Not defined>	6H21+6H25	G-2	[X]
300mm	M_Concrete-Round-Column	IfcColumn	Yes	Multi-Tier	300 mm	Yes	Detail 1	Detail 1	Pinned	Pinned	CIS	<Not defined>	6H21+6H25	H-2	[X]
300mm	M_Concrete-Round-Column	IfcColumn	Yes	Multi-Tier	300 mm	Yes	Detail 1	Detail 1	Pinned	Pinned	CIS	<Not defined>	6H21+6H25	A-3	[X]
300mm	M_Concrete-Round-Column	IfcColumn	Yes	Multi-Tier	300 mm	Yes	Detail 1	Detail 1	Pinned	Pinned	CIS	<Not defined>	6H21+6H25	B-3	[X]
300mm	M_Concrete-Round-Column	IfcColumn	Yes	Multi-Tier	300 mm	Yes	Detail 1	Detail 1	Pinned	Pinned	CIS	<Not defined>	6H21+6H25	C-3	[X]
300mm	M_Concrete-Round-Column	IfcColumn	Yes	Multi-Tier	300 mm	Yes	Detail 1	Detail 1	Pinned	Pinned	CIS	<Not defined>	6H21+6H25	D-3	[X]
300mm	M_Concrete-Round-Column	IfcColumn	Yes	Multi-Tier	300 mm	Yes	Detail 1	Detail 1	Pinned	Pinned	CIS	<Not defined>	6H21+6H25	E-3	[X]

Undefined parameters can be reviewed at a glance

2- Coordinate and manage models within Revizto

Review undefined parameter in colour coding

Appearance Template

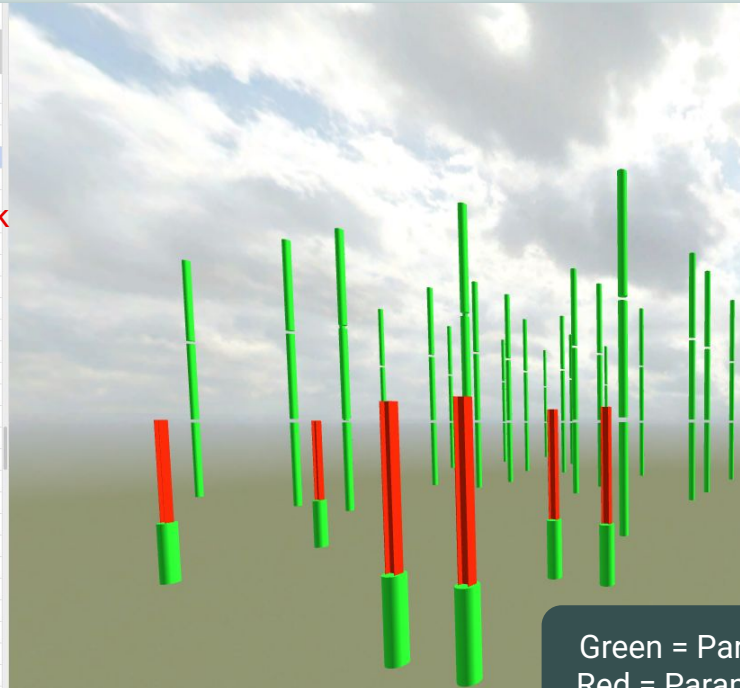
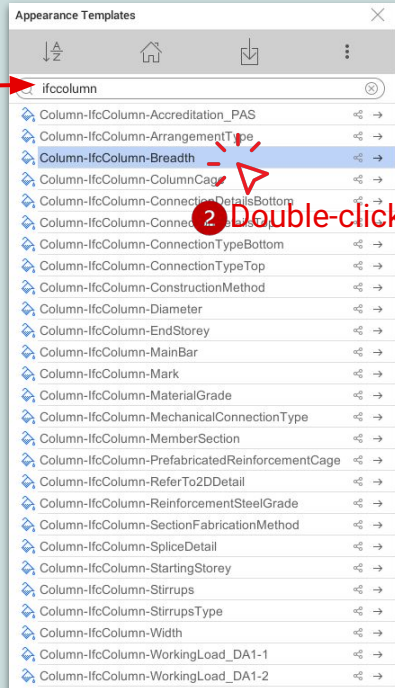

Green = Parameter defined
Red = Parameter undefined

3.1- Switchback from Revizto to the authoring tool

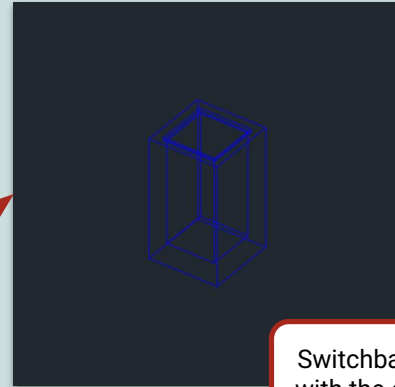
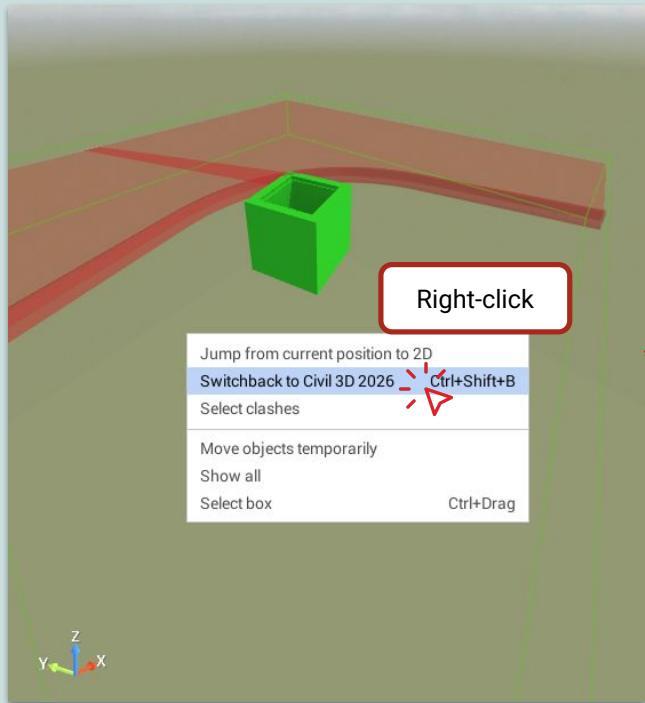

Switchback to authoring tool with the exact isometric view

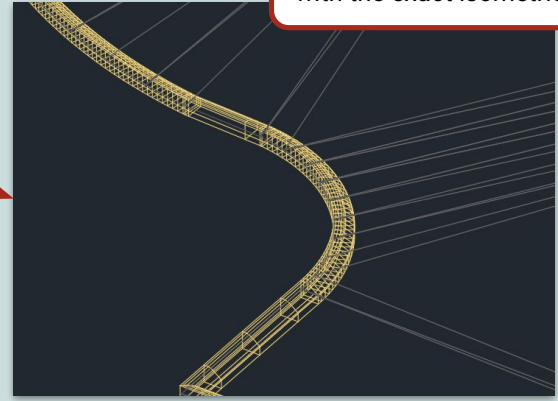

02

Implementing Revizto presets for CORENET X workflows



Locating and preparing preset files

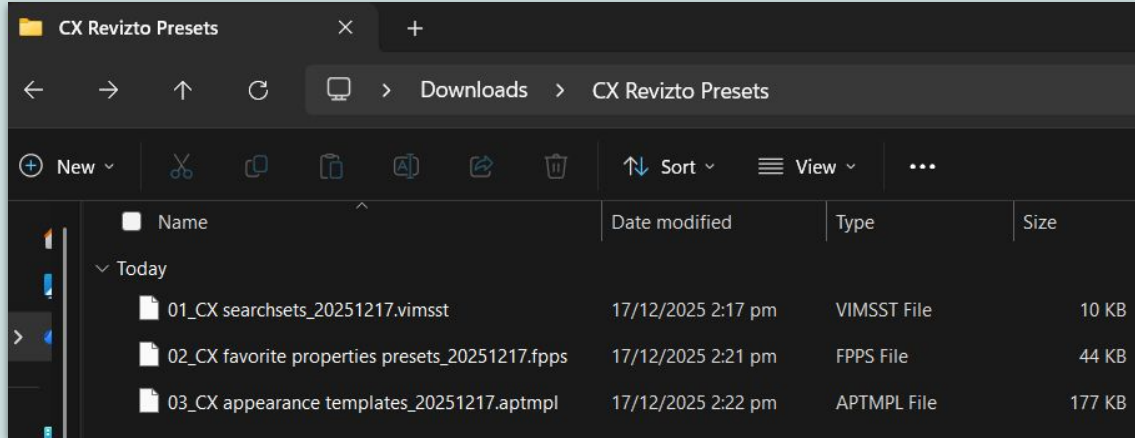

1. **Download:** Access the latest Preset Files by clicking [here](#).
2. **Extract:** Ensure the downloaded ZIP folder is fully extracted to a local directory before attempting to import the files into your Revizto project.

⚠ Important maintenance note:
To ensure ongoing compliance, these preset files are subject to periodic reviews. In the event of an update to the CORENET X Code of Practice (COP), the presets will be updated accordingly. Users are encouraged to verify they are using the most current version prior to each major submission milestone.

Step-by-step: Importing presets into Revizto

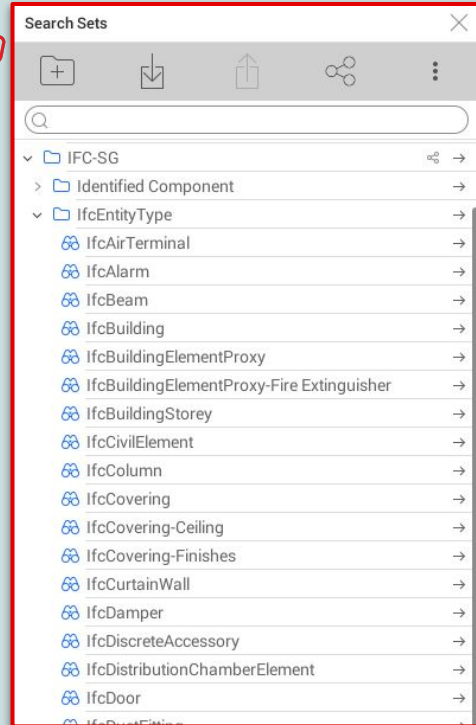
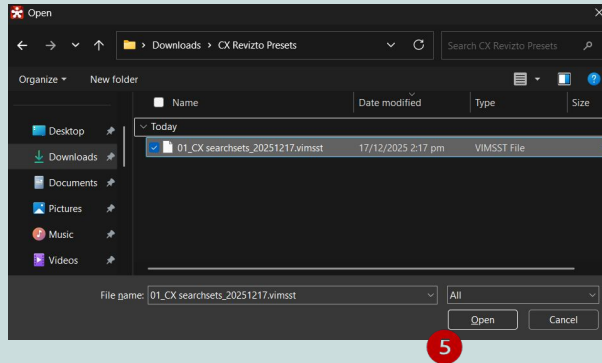
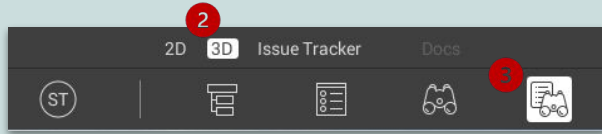

Importing search set:

1. In the Revizto application, open a project.
2. At the top of the application window, click **3D**.
3. On the top toolbar, click **Search Sets**.
4. At the top of the **Search Sets** pane, click **import**.
5. Select a file and click **open**.

Step-by-step: Importing presets into Revizto

Simple view:

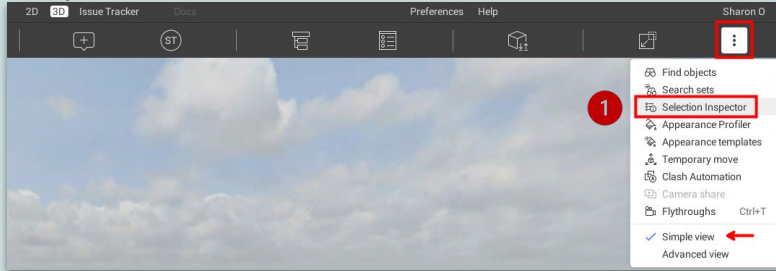

Advanced view:

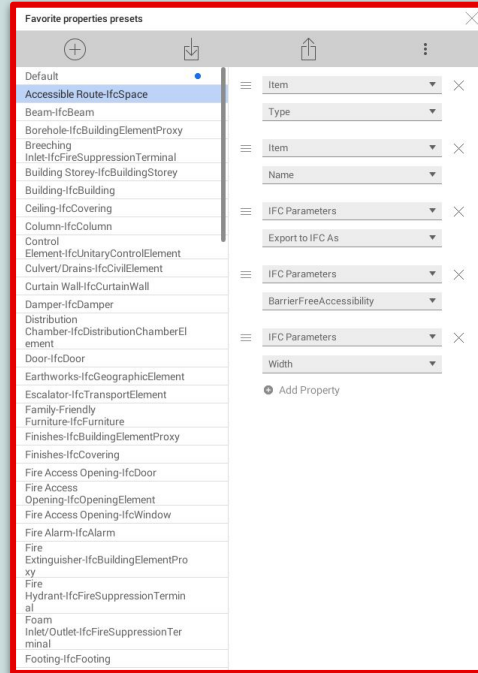
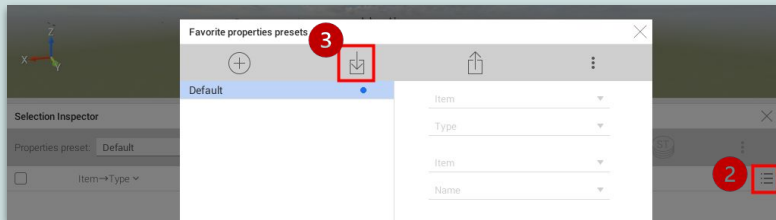
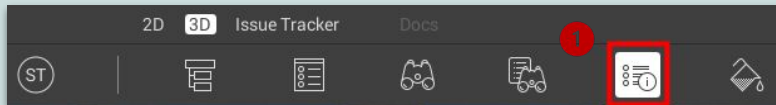

Importing favorite properties:

1. Open the **Selection Inspector** pane by clicking **more** on the toolbar and selecting Selection Inspector, or by clicking **Selection Inspector** when in advanced view.
2. Open the **Favorite Properties** presets window.
3. Click **Import** to import the selected property to a preset file (.fpps).

Note for Favorite Properties

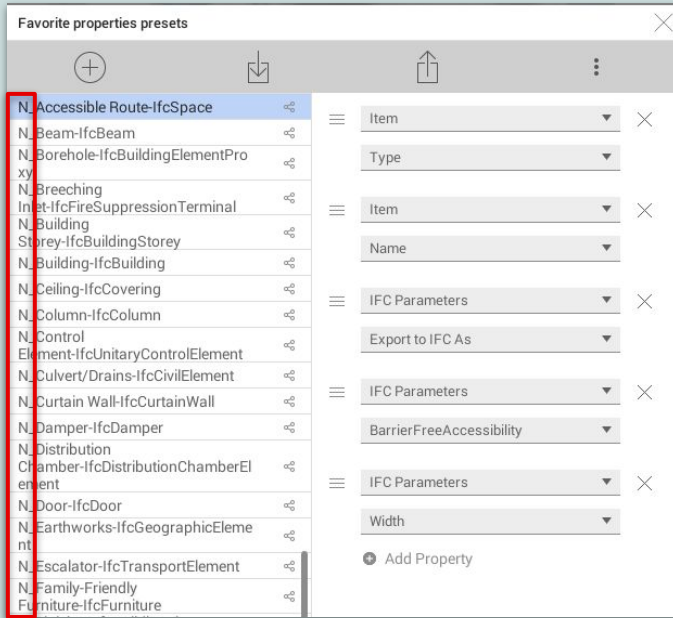

 **Focus only on presets beginning with "N":**
N - Utilised for checking native models

Step-by-step: Importing presets into Revizto

Simple view:

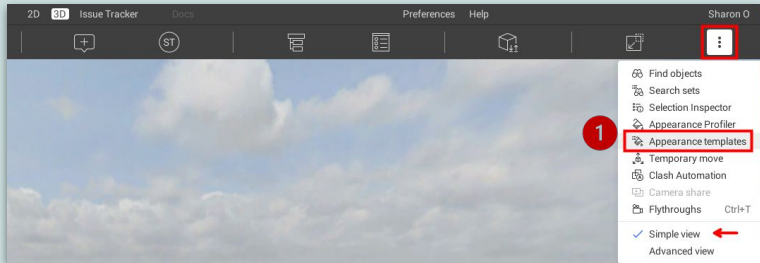

Advanced view:

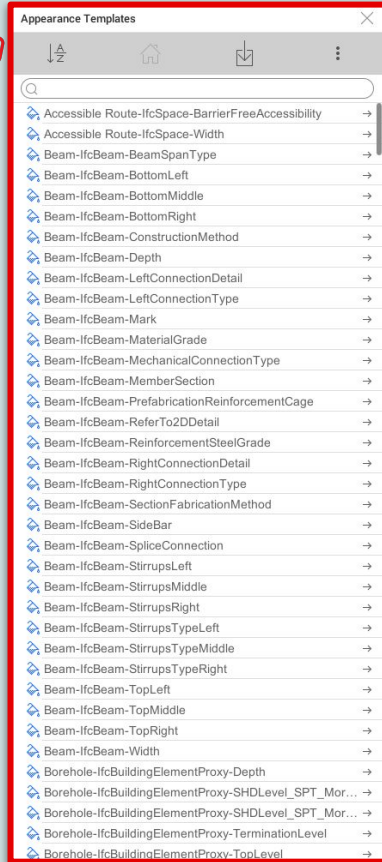
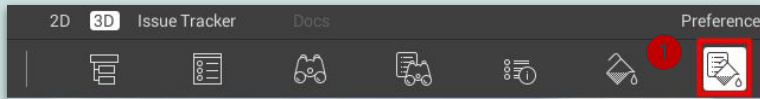

Importing appearance templates:

1. Open the **Appearance Template** pane by clicking **more** on the toolbar and selecting Appearance Template, or by clicking **Appearance Template** when in advanced view.
2. Click **import** to import the selected template to a preset file (.aptmpl).

03

Support & feedback



Support & feedback

We are committed to the continuous improvement of our tools to better serve the industry. As the CORENET X standards evolve, your insights are invaluable.

If you have any feedback regarding the Revizto presets, or if you require technical clarification on the application, please contact our team:

Primary contact:

Sharon Ooi - Industry Consultant (lm.ooi@revizto.com)

Secondary contact:

Chris Mawson - Reg. CS Director (APAC) (c.mawson@revizto.com)



REVIZTO.COM

When it has to be made right,
it has to be Revizto.

Thank you.

 revizto